



**Professional
3 LED
Dive Light**

Phantom

LED Dive Lights

OWNER'S MANUAL



Item:

L197LED3-K

OMS LLC



Phantom

LED Dive Lights

The new OMS 1 LED, 3 LED, and 7 LED lights are very similar and designed for use underwater to an operational depth of 660 feet seawater. To insure watertight reliability, each light is tested to a depth of 328 fsw. The light heads are very compact, and equipped with very high output Light Engines. Several features are unique: A head-mounted ON-OFF switch (magnetically activated reed switch), unique shock-mounted 1 LED light engine, a smart battery and an international charger, and an O-Ring sealed hose containing the wires.



ON/OFF Switch

With screw down lock on back of light head

Canister Mounting Hardware:
Stainless steel bands with quick links



Optional
soft mount
Goodman
handle.



Front view



Back view

Before you start:

The OMS® LED lights are shipped from the factory with the battery in a partially charged state. The unit must be fully charged before its first use (see charge instructions below).

WARNING: Use only the OMS® charger, as other chargers may damage the light. Recharge the battery after every use, as deep discharge will reduce life. Charger should be attached to battery before the plug is inserted into the AC socket. Never fully discharge the battery.

The float charger is automatic for all lights and charge state of the battery is indicated by an LED either located on the battery or on the charger. RED LED indicates that it is charging, and a green LED indicates that the battery is fully charged.

Charging the batteries:

1. Unscrew the bottom cap of the battery canister (the cap without the light cord). Use 2 strap wrenches if difficult to unscrew. Do not use metal tools, as they will damage the cap and canister.
2. Disconnect the male and female Molex connectors and attach the appropriate connector from the charger to the connector of the battery.
3. **Charging:** After charging, unclip the connectors by holding the plastic connectors and gently pull apart. Reconnect the light head male Molex connector to the battery female Molex connector.
4. **Inspect the Cap:** Make sure that the threads and O-Rings are not damaged, clean and free from dirt or debris to prevent flooding.
5. **Caution:** The top metal cap is not to be removed unless servicing is required. Have this O-Ring factory serviced every 5 years.

Reassembling Top or Bottom Battery Canister Caps: Caution: Lubricate threads of cap and inner threads of PVC canister with silicone grease before reassembly. Carefully place the inner part of the cap into the canister. Turn cap slightly counter clockwise until you hear the cap "seat," then proceed to turn cap clockwise until it is completely tight.

If necessary use "rubber friction gripper pads" to tighten caps (DO NOT USE TOOLS). **Caution:** If the cap becomes very hard to turn during assembly, STOP, back it off, and carefully reassemble. If you are unable to completely seat cap into canister, obtain an RMA from OMS and send the light in for repair. Check to make sure that the canister clamp is not on too tight, as this too can prevent the cap from seating in properly.

Removing the Battery:

1. Before starting, secure the light head so it does not fall (place in pocket or place on a carpeted floor).
2. Unscrew the bottom battery canister cap.
3. Disconnect the battery female Molex connector from the lighthead male Molex Connector.
4. Slide battery out.

Disconnecting the battery for travel: Unscrew the bottom canister cap, then disconnect the light head and battery Molex connectors. **DO NOT REMOVE THE TOP METAL CAP.** Your light head is equipped with a switch lock. With the switch in the off position, screw in this lock to deactivate the switch. Reinstall the canister cap.

Reinstalling the Battery:

1. Before starting, secure the light head so it does not fall (place in pocket or place on floor).
2. Unscrew the bottom canister cap.
3. Slide the wireless (or short wire) end of the battery into the canister alongside of the light head Molex cable.
4. Reconnect the battery and light cable Molex connectors and place them in the recess of the bottom battery cap.
5. Lubricate and replace the battery cap.

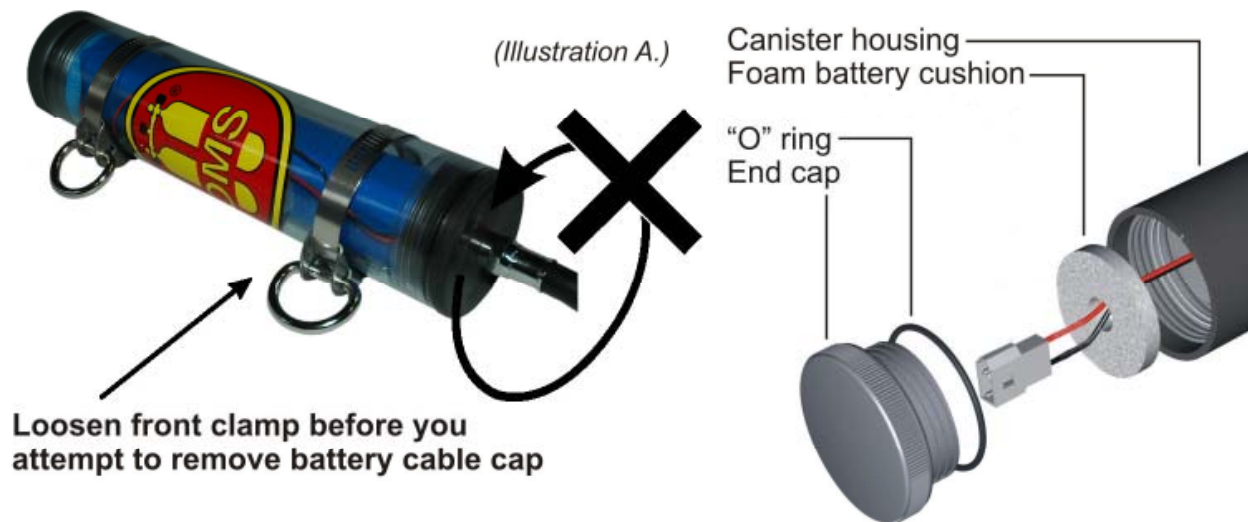

Note:

We recommend returning the light to an OMS® authorized repair center or OMS® for light engine replacement. We will install the engine and pressure test the unit, which will maintain the warranty. Incorrect installation or installation by anyone other than an authorized OMS® technician may cause flooding and void warranty.

What to do in case of flooded light:

Turn off immediately. Completely disassemble all parts and place in distilled water. Remove and dry thoroughly. Return to OMS® by obtaining an RMA number.

Procedure for service or making a warranty claim:

Contact OMS® for a return authorization number and state reason (i.e. service, repair or warranty issue). CALL 1-845-457-1501.

Batteries: 12V (Lithium) for 1 LED light and a 16.67 VDC battery for the 3 and 7 LED lights with float protection.





WARNING AND CAUTION

- Use only underwater
- Do NOT look directly into the lamp - can cause eye damage.
- Use only with OMS charger.
- When traveling or shipping, always disconnect the battery to prevent accidental activation of the light. Failure to disconnect the battery during travel and/or when the light is in close proximity to combustible materials like divegear, may result in fire damage (see instructions on removing battery).

Mounting canister: Side of back plate (a.), bottom of back plate (b.), belt mount (c.), top of valves (d.), nested between double tanks (e.).



LED Lights

Light Type	Item #	Wt/Buoyancy	Burn Time*	Avg. LED Life**	Output	Focus	1/2 Beam Angle	LED	Battery
Phantom 10W Canister	L197LED1-K	2.71 / -.87 lbs.	10 hrs	10,000 hrs	500 Lm@12.58ft (3.84M)	Fixed	6°	1	12V, 4.4Ah Rechargeable Lithium
Phantom 12W Canister	L197LED3-K	3.78 / -1.33 lbs.	7.5 hrs	10,000 hrs	1100 Lm@12.58ft (3.84M)	Fixed	6°	3	16V, 6Ah Rechargeable Lithium
Phantom 24W Canister	L197LED20-K	4.34 / -1.58 lbs.	3.26 hrs	10,000 hrs	2600 Lm@12.58ft (3.84M)	Fixed	6°	7	16V, 6Ah Rechargeable Lithium

Battery Canister Specifications

Light Type	Item #	Depth	Sealing	Material	Cord	Weight	Dimensions	Bulkhead
Phantom 10W Canister	L197LED1-K	800 FSW	O-Ring Cap/Canister	PVC Canister	4' w/ O-Ring Seal	2.71 lbs w/battery	7.5" x 2.37" O.D.	O-Ring Seal
Phantom 12W Canister	L197LED3-K	800 FSW	O-Ring Cap/Canister	PVC Canister	4' w/ O-Ring Seal	3.78 lbs w/battery	10.25" x 2.37" O.D.	O-Ring Seal
Phantom 24W Canister	L197LED20-K	800 FSW	O-Ring Cap/Canister	PVC Canister	4' w/ O-Ring Seal	4.34 lbs w/battery	10.25" x 2.37" O.D.	O-Ring Seal

Charger Specifications

Light Type	Item #	Charger Item	Primaries	Secondaries	Float	Indicator
Phantom 10W Canister	L197LED1-K	L-209-K	Wall 100-240 VAC	12 VDC @ 1.0A	Yes	Red charging / Green fully charged
Phantom 12W Canister	L197LED3-K	L-217-CHG	Wall 100-240 VAC	12 VDC @ 2.5A	Yes	Red charging / Green fully charged
Phantom 24W Canister	L197LED20-K	L-217-CHG	Wall 100-240 VAC	12 VDC @ 2.5A	Yes	Red charging / Green fully charged

*Burn times are approximate and are dependent on temperature and depth of battery charge

**Avg. Life @ 10,000 hrs. is defined by ANSI as follows:

Equipment for Underwater Exploration™

LIMITED WARRANTY OMS® PHANTOM DIVE LIGHTS

OMS® will, at its sole option, repair or replace (with a new or refurbished unit) any Phantom™ dive light or divelight components deemed by OMS® to be defective in manufacture for a period of 1 year for the Original Retail Purchaser (Proof of Purchase required). The product must have been purchased from an authorized OMS® retailer. If you are unsure if the retailer is authorized, log onto www.omsdive.com or call OMS® at 845-457-1501.

Exclusions:

1. This warranty does not cover modification to the product, accidents, abuse, neglect, or misuse. This includes, but is not limited to: (a) Charging the battery with a charger other than an OMS® charger. (b) Failure to properly maintain and lubricate all o-rings. (c) Leakage due to failure to properly close caps, install lens clips, and o-rings, and/or disassembly/assembly by anyone other than an OMS® trained and certified technician. (d) Damage resulting from dropping the light. (e) Transportation or shipping damage. (f) Fires and subsequent damage due to misuse of product, including but not limited to transporting the light with the battery connected.
2. OMS® batteries with labels are date coded and warranted for a period of 90 days after date of purchase. Batteries with missing, illegible, or altered labels are not warranted.
3. This warranty specifically excludes bulbs, o-rings, and lenses
4. Retail or commercial use.
5. This warranty cannot be extended for any reason.
6. Claims made for damages in conjunction with a diving accident are excluded.

Warranty Claim Procedure: Call or fax OMS® with a description of the problem and submit original proof of purchase. If the problem cannot be resolved over the phone, obtain an RMA number. Owner will be responsible for all freight costs. If the light is found not to be covered by the OMS® warranty, an estimate of repair charges will be sent to you. The repair cost may be more or less than the repair estimate.

Tests Conducted Prior to Shipment:

1. Pressure test in a wet chamber to 328 FSW to verify water tightness.
2. Lighting test: Verifies that the bulb lights.
3. Battery Test: Verifies that the battery is charging properly and delivers proper V and A.

Specifications subject to change at any time.



OMS LLC
P.O. Box 146 • Montgomery, NY 12549
Tel: 845.457.1501 • Fax: 845.457.1504

www.omsdive.com
© OMS LLC